

Solar smart seat product selection manual

September 1, 2020

Hangzhou Sanqian Smart City Technology Co., LTD



Solar multi-functional intelligent seat is a kind of use of clean energy solar energy as a seat power supply system, but also with wireless charging, Bluetooth module, WLAN, audio, LED induction lights and other convenient intelligent functions, can enjoy the convenience and fashion brought by intelligence. Set popular fashion elements, low-carbon environmental protection concept, artificial intelligence operation, business operation model, landscape leisure and entertainment in one of the multi-functional smart seats.



Product Model: SVIP-3A21-1

1. The main structure of the smart chair: 1.5mm galvanized steel plate, anti-corrosion wood/plastic wood
2. Monocrystalline silicon solar panel power generation system: 90W
3. Photovoltaic intelligent control system (MPPT export level)
4. Lithium iron phosphate battery * 1:48AH
5. USB3.0 Fast Charging *2 (5V/2.1A)
6. Wireless charging module *2(5V-2A,10W)
7. Voltage conversion module *1(12V-5V/20A/22W)
8. WiFi*1 4G router *1(2-25m)
9. Bluetooth Audio module *1 (5V)
10. LED lighting system *1(12V/10W light sense/time control)

Size: 800*800*2650mm

Optional features:

1. Intelligent dialog voice module
2. 5G router
3. Remote control system module (mobile phone real-time view status)
4. Power display module
5. One-click alarm system
6. Mains function



Product Model: SVIP-3A21-2

1. Smart chair main structure: 1.5mm galvanized steel plate
2. Monocrystalline silicon solar panel power generation system: 80W
3. Photovoltaic intelligent control system (MPPT export level)
4. Lithium iron phosphate battery * 1:48AH
5. USB3.0 Fast Charging *2 (5V/2.1A)
6. Wireless charging module *2(5V-2A,10W)
7. Voltage conversion module *1(12V-5V/20A/22W)
8. WiFi*1 4G router *1(2-25m)
9. Bluetooth Audio module *1 (5V)
10. LED lighting system *1(12V/10W light sense/time control)

Size: 1700*450*450mm Color: customizable

Optional features:

1. Intelligent dialog voice module
2. 5G router
3. Remote control system module (mobile phone real-time view status)
4. Power display module
5. One-click alarm system
6. Mains function



Product Model: SVIP-3A21-3

1. The main structure of the smart chair: 1.5mm galvanized steel plate, anti-corrosion wood/plastic wood
2. Monocrystalline silicon solar panel power generation system: 80W
3. Photovoltaic intelligent control system (MPPT export level)
4. Lithium iron phosphate battery * 1:48AH
5. USB3.0 Fast Charging *2 (5V/2.1A)
6. Wireless charging module *1(5V-2A,10W)
7. Voltage conversion module *1(12V-5V/20A/22W)
8. WiFi*1 4G router *1(2-25m)
9. Bluetooth Audio module *1 (5V)
10. LED lighting system *1(12V/10W light sense/time control)

Size: 1800*450*2460mm Color: customizable

Optional features:

1. Intelligent dialog voice module
2. 5G router
3. Remote control system module (mobile phone real-time view status)
4. Power display module
5. One-click alarm system
6. Mains function



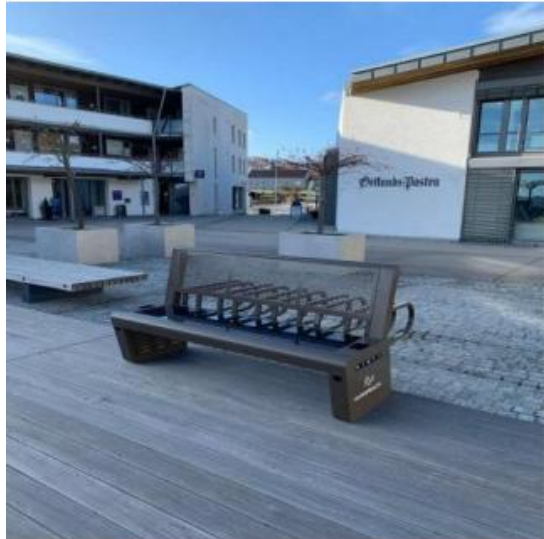
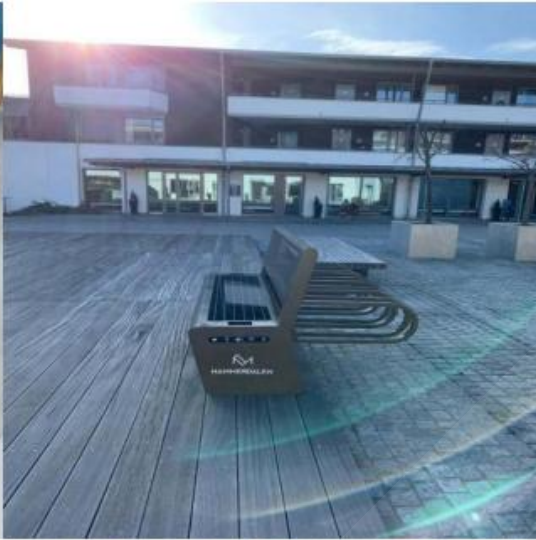

Product model: SVIP-3A21-A

1. Smart chair main structure: 1.5mm galvanized steel plate
2. Monocrystalline silicon solar panel power generation system: 80W
3. Photovoltaic intelligent control system (MPPT export level)
4. Lithium iron phosphate battery * 1:48AH
5. USB3.0 Fast Charging *2 (5V/2.1A)
6. Wireless charging module *2(5V-2A,10W)
7. Voltage conversion module *1(12V-5V/20A/22W)
8. WiFi*1 4G router *1(2-25m)
9. Bluetooth Audio module *1 (5V)
10. LED lighting system *1(12V/10W light sense/time control)

Size: 1700*450*735mm Color: customizable

Optional features:

1. Intelligent dialog voice module
2. 5G router
3. Remote control system module (mobile phone real-time view status)
4. Power display module
5. One-click alarm system
6. Mains function



Product Model: SVIP-3A21-5

1. The main structure of the smart chair: 1.5mm galvanized steel plate /304 stainless steel, anti-corrosion wood/plastic wood
2. Monocrystalline silicon solar panel power generation system: 80W
3. Photovoltaic intelligent control system (MPPT export level)
4. Lithium iron phosphate battery * 1:48AH
5. USB3.0 Fast Charging *1 (5V/2.1A)
6. Wireless charging module *1(5V-2A,10W)
7. Voltage conversion module *1(12V-5V/20A/22W)
8. WiFi*1 4G router *1(2-25m)
9. Bluetooth Audio module *1 (5V)
10. LED lighting system *1(12V/10W light sense/time control)
11. LED advertising lighting box *1(12V/10W light sense/time control)

Size: 650*550*2360mm Color: customizable

Optional features:

1. Intelligent dialog voice module
2. 5G router
3. Remote control system module (mobile phone real-time view status)
4. Power display module
5. One-click alarm system
6. Mains function



Product Model: SVIP-3A21-6

1. Smart chair main structure: 1.5mm galvanized steel plate
2. Monocrystalline silicon solar panel power generation system: 80W
3. Photovoltaic intelligent control system (MPPT export level)
4. Lithium iron phosphate battery * 1:48AH
5. USB3.0 Fast Charging *2 (5V/2.1A)
6. Wireless charging module *2(5V-2A,10W)
7. Voltage conversion module *1(12V-5V/20A/22W)
8. WiFi*1 4G router *1(2-25m)
9. Bluetooth Audio module *1 (5V)
10. LED lighting system *1(12V/10W light sense/time control)

Size: 1700*450*450mm Color: white/black

Optional features:

1. Intelligent dialog voice module
2. 5G router
3. Remote control system module (mobile phone real-time view status)
4. Power display module
5. One-click alarm system
6. Mains function



Product model: SVIP-3A21-7

1. Smart chair main structure: 1.5mm galvanized steel plate
2. Monocrystalline silicon solar panel power generation system: 80W
3. Photovoltaic intelligent control system (MPPT export level)
4. Lithium iron phosphate battery * 1:48AH
5. USB3.0 Fast Charging *2 (5V/2.1A)
6. Wireless charging module *2(5V-2A,10W)
7. Voltage conversion module *1(12V-5V/20A/22W)
8. WiFi*1 4G router *1(2-25m)
9. Bluetooth Audio module *1 (5V)
10. LED lighting system *1(12V/10W light sense/time control)

Size: 1700*450*450mm Color: wood grain color

Optional features:

1. Intelligent dialog voice module
2. 5G router
3. Remote control system module (mobile phone real-time view status)
4. Power display module
5. One-click alarm system
6. Mains function



Product Model: SVIP-3A21-8

1. The main structure of the smart chair: 1.5mm galvanized steel plate, anti-corrosion wood/plastic wood
 2. Monocrystalline silicon solar panel power generation system: 50W
 3. Photovoltaic intelligent control system (MPPT export level)
 4. Lithium iron phosphate battery * 1:30 AH
 5. USB3.0 Fast Charging *2 (5V/2.1A)
 6. Wireless charging module *2(5V-2A,10W)
 7. Voltage conversion module *1(12V-5V/20A/22W)
 8. WiFi*1 4G router *1(2-25m)
 9. Bluetooth Audio module *1 (5V)
 10. LED lighting system *1(12V/10W light sense/time control)
- Size: 1900*450*650mm Color: white/gray

Optional features:

1. Intelligent dialog voice module
2. 5G router
3. Remote control system module (mobile phone real-time view status)
4. Power display module
5. One-click alarm system
6. Mains function



Product model: SVIP-3A21-9

1. The main structure of the smart chair: 1.5mm galvanized steel plate, anti-corrosion wood/plastic wood
 2. Monocrystalline silicon solar panel power generation system: 80W
 3. Photovoltaic intelligent control system (MPPT export level)
 4. Lithium iron phosphate battery * 1:48AH
 5. USB3.0 Fast Charging *2 (5V/2.1A)
 6. Wireless charging module *2(5V-2A,10W)
 7. Voltage conversion module *1(12V-5V/20A/22W)
 8. WiFi*1 4G router *1(2-25m)
 9. Bluetooth Audio module *1 (5V)
 10. LED lighting system *1(12V/10W light sense/time control)
- Size: 1800*1400*800mm Color: white

Optional features:

1. Intelligent dialog voice module
2. 5G router
3. Remote control system module (mobile phone real-time view status)
4. Power display module
5. One-click alarm system
6. Mains function



Product model: SVIP-3A21-10

1. Smart chair main structure: 1.5mm galvanized steel plate
2. Monocrystalline silicon solar panel power generation system: 300W
3. Photovoltaic intelligent control system (MPPT export level)
4. Lithium iron phosphate battery * 1:80AH
5. USB3.0 Fast Charging *2 (5V/2.1A)
6. Wireless charging module *2(5V-2A,10W)
7. Voltage conversion module *1(12V-5V/20A/22W)
8. WiFi*1 4G router *1(2-25m)
9. Bluetooth Audio module *1 (5V)
10. LED lighting system *1(12V/10W light sense/time control)

Size: 1900*1800*2450mm Color: customized

Optional features:

7. Intelligent dialogue voice module
8. 5G router
9. Remote control system module (mobile phone real-time view status)
10. Power display module
11. One-click alarm system
12. Mains function



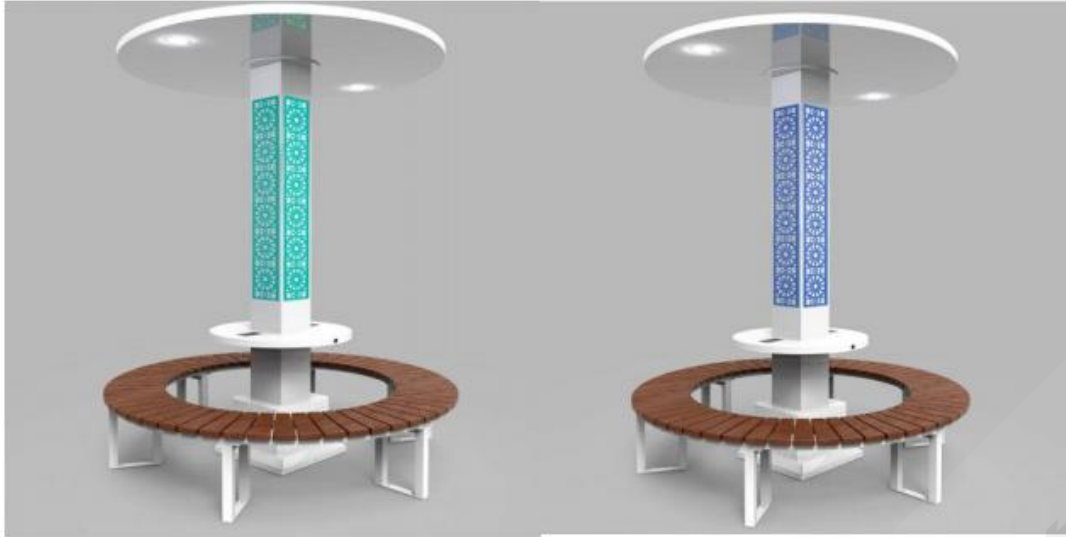

Product model: SVIP-3A21-11

1. The main structure of the smart chair: 1.5mm galvanized steel plate, anti-corrosion wood/plastic wood
2. Monocrystalline silicon solar panel power generation system: 120W
3. Photovoltaic intelligent control system (MPPT export level)
4. Lithium iron phosphate battery * 1:55AH
5. USB3.0 Fast Charging *2 (5V/2.1A)
6. Wireless charging module *2(5V-2A,10W)
7. Voltage conversion module *1(12V-5V/20A/22W)
8. WiFi*1 4G router *1(2-25m)
9. Bluetooth Audio module *1 (5V)
10. LED lighting system *1(12V/10W light sense/time control)

Size: 1400*1400*2450mm Color: customized

Optional features:

1. Intelligent dialog voice module
2. 5G router
3. Remote control system module (mobile phone real-time view status)
4. Power display module
5. One-click alarm system
6. Mains function

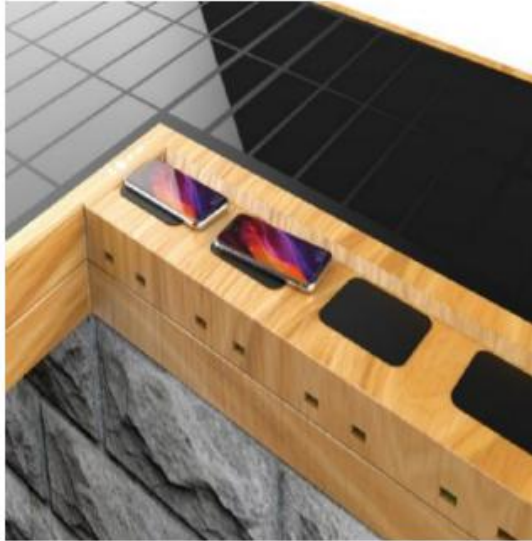

Product model: SVIP-3A21-12

1. Smart chair main structure: 1.5mm galvanized steel plate
2. Monocrystalline silicon solar panel power generation system power: 100W
3. Photovoltaic intelligent control system (MPPT export level)
4. Lithium iron phosphate battery * 1:48AH
5. USB3.0 Fast Charging *2 (5V/2.1A)
6. Wireless charging module *2(5V-2A,10W)
7. Voltage conversion module *1(12V-5V/20A/22W)
8. WiFi*1 4G router *1(2-25m)
9. Bluetooth Audio module *1 (5V)
10. LED lighting system *1(12V/10W light sense/time control)

Size: 1400*1400*2450mm Color: imitation stone pattern

Optional features:

1. Intelligent dialog voice module
2. 5G router
3. Remote control system module (mobile phone real-time view status)
4. Power display module
5. One-click alarm system
6. Mains function



Product Model: SVIP-3A21-13

1. Smart chair main structure: 1.5mm galvanized steel plate
2. Monocrystalline silicon solar panel power generation system: 80W
3. Photovoltaic intelligent control system (MPPT export level)
4. Lithium iron phosphate battery * 1:48AH
5. USB3.0 Fast Charging *2 (5V/2.1A)
6. Wireless charging module *2(5V-2A,10W)
7. Voltage conversion module *1(12V-5V/20A/22W)
8. WiFi*1 4G router *1(2-25m)
9. Bluetooth Audio module *1 (5V)
10. LED lighting system *1(12V/10W light sense/time control)

Size: 2000*450*450mm/1800*450*450mm Color: customized

Optional features:

1. Intelligent dialog voice module
2. 5G router
3. Remote control system module (mobile phone real-time view status)
4. Power display module
5. One-click alarm system
6. Mains function



Product Model: SVIP-3A21-1A

1. Smart chair main structure: 1.5mm galvanized steel plate
2. Monocrystalline silicon solar panel power generation system: 80W
3. Photovoltaic intelligent control system (MPPT export level)
4. Lithium iron phosphate battery * 1:48AH
5. USB3.0 Fast Charging *2 (5V/2.1A)
6. Wireless charging module *2(5V-2A,10W)
7. Voltage conversion module *1(12V-5V/20A/22W)
8. WiFi*1 4G router *1(2-25m)
9. Bluetooth Audio module *1 (5V)
10. LED lighting system *1(12V/10W light sense/time control)

Size: 2000*450*735mm/1700*450*735mm Color: wood grain color

Optional features:

1. Intelligent dialog voice module
2. 5G router
3. Remote control system module (mobile phone real-time view status)
4. Power display module
5. One-click alarm system
6. Mains function



Product model: SVIP-3A21-15

1. Smart chair main structure: 1.5mm galvanized steel plate
2. Monocrystalline silicon solar panel power generation system: 80W
3. Photovoltaic intelligent control system (MPPT export level)
4. Lithium iron phosphate battery * 1:48AH
5. USB3.0 Fast Charging *2 (5V/2.1A)
6. Wireless charging module *2(5V-2A,10W)
7. Voltage conversion module *1(12V-5V/20A/22W)
8. WiFi*1 4G router *1(2-25m)
9. Bluetooth Audio module *1 (5V)
10. LED lighting system *1(12V/10W light sense/time control)

Size: 2000*450*735mm/1700*450*735mm Color: customized

Optional features:

1. Intelligent dialog voice module
2. 5G router
3. Remote control system module (mobile phone real-time view status)
4. Power display module
5. One-click alarm system
6. Mains function



Product Model: SVIP-3A21-16

1. Smart chair main structure: 1.5mm galvanized steel plate
 2. Monocrystalline silicon solar panel power generation system: 80W
 3. Photovoltaic intelligent control system (MPPT export level)
 4. Lithium iron phosphate battery * 1:48AH
 5. USB3.0 Fast Charging *2 (5V/2.1A)
 6. Wireless charging module *2(5V-2A,10W)
 7. Voltage conversion module *1(12V-5V/20A/22W)
 8. WiFi*1 4G router *1(2-25m)
 9. Bluetooth Audio module *1 (5V)
 10. LED lighting system *1(12V/10W light sense/time control)
- Size: 2000*450*735mm/1700*450*735mm Color: customized

Optional features:

1. Intelligent dialog voice module
2. 5G router
3. Remote control system module (mobile phone real-time view status)
4. Power display module
5. One-click alarm system
6. Mains function



Product model: SVIP-3A21-17

1. The main structure of the smart chair: 1.5mm galvanized steel plate, anti-corrosion wood/plastic wood
2. USB3.0 Fast Charging *2 (5V/2.1A)
3. Wireless charging module *2(5V-2A,10W)
4. Voltage conversion module *1(220V-12V,12V-5V/20A/22W)
5. WiFi*1 4G router *1(2-25m)
6. Bluetooth Audio module *1 (5V)
7. LED lighting system *1(12V/10W light sense/time control)

Size: 1700*450*735mm Color: customized

Optional features:

1. Intelligent dialog voice module
2. 5G router
3. One-click alarm system



Product Model: SVIP-3A21-18

1. The main structure of the smart chair: 1.5mm galvanized steel plate, anti-corrosion wood/plastic wood
2. Monocrystalline silicon solar panel power generation system: 80W
3. Photovoltaic intelligent control system (MPPT export level)
4. Lithium iron phosphate battery * 1:48AH
5. USB3.0 Fast Charging *2 (5V/2.1A)
6. Wireless charging module *2(5V-2A,10W)
7. Voltage conversion module *1(12V-5V/20A/22W)
8. WiFi*1 4G router *1(2-25m)
9. Bluetooth Audio module *1 (5V)
10. LED lighting system *1(12V/10W light sense/time control)
11. LED advertising lighting box *1(12V/10W light sense/time control)

Size: 2000*550*2350mm Color: customized

Optional features:

1. Intelligent dialog voice module
2. 5G router
3. Remote control system module (mobile phone real-time view status)
4. Power display module
5. One-click alarm system
6. Mains function



Product model: SVIP-3A21-19

1. The main structure of the smart chair: 1.5mm galvanized steel plate, anti-corrosion wood/plastic wood
2. Monocrystalline silicon solar panel power generation system: 80W
3. Photovoltaic intelligent control system (MPPT export level)
4. Lithium iron phosphate battery * 1:48AH
5. USB3.0 Fast Charging *2 (5V/2.1A)
6. Wireless charging module *2(5V-2A,10W)
7. Voltage conversion module *1(12V-5V/20A/22W)
8. WiFi*1 4G router *1(2-25m)
9. Bluetooth Audio module *1 (5V)
10. LED lighting system *1(12V/10W light sense/time control)

Size: 2100*550*2200mm Color: customized

Optional features:

1. Intelligent dialog voice module
2. 5G router
3. Remote control system module (mobile phone real-time view status)
4. Power display module
5. One-click alarm system
6. Mains function



Product model: SVIP-3A21-20

1. The main structure of the smart chair: 1.5mm galvanized steel plate, anti-corrosion wood/plastic wood
2. Monocrystalline silicon solar panel power generation system: 80W
3. Photovoltaic intelligent control system (MPPT export level)
4. Lithium iron phosphate battery * 1:48AH
5. USB3.0 Fast Charging *2 (5V/2.1A)
6. Wireless charging module *2(5V-2A,10W)
7. Voltage conversion module *1(12V-5V/20A/22W)
8. WiFi*1 4G router *1(2-25m)
9. Bluetooth Audio module *1 (5V)
10. LED lighting system *1(12V/10W light sense/time control)

Size: 2100*550*2200mm Color: customized

Optional features:

1. Intelligent dialog voice module
2. 5G router
3. Remote control system module (mobile phone real-time view status)
4. Power display module
5. One-click alarm system
6. Mains function



Product Model: SVIP-3A21-21

1. The main structure of the smart chair: 1.5mm galvanized steel plate, anti-corrosion wood/plastic wood
2. Monocrystalline silicon solar panel power generation system: 80W
3. Photovoltaic intelligent control system (MPPT export level)
4. Lithium iron phosphate battery * 1:48AH
5. USB3.0 Fast Charging *2 (5V/2.1A)
6. Wireless charging module *2(5V-2A,10W)
7. Voltage conversion module *1(12V-5V/20A/22W)
8. WiFi*1 4G router *1(2-25m)
9. Bluetooth Audio module *1 (5V)
10. LED lighting system *1(12V/10W light sense/time control)

Size: 2000*550*2200mm Color: customized

Optional features:

1. Intelligent dialog voice module
2. 5G router
3. Remote control system module (mobile phone real-time view status)
4. Power display module
5. One-click alarm system
6. Mains function



Product Model: SVIP-3A21-22

1. The main structure of the smart chair: 1.5mm galvanized steel plate, anti-corrosion wood/plastic wood
 2. Monocrystalline silicon solar panel power generation system: 80W
 3. Photovoltaic intelligent control system (MPPT export level)
 4. Lithium iron phosphate battery * 1:48AH
 5. USB3.0 Fast Charging *2 (5V/2.1A)
 6. Wireless charging module *2(5V-2A,10W)
 7. Voltage conversion module *1(12V-5V/20A/22W)
 8. WiFi*1 4G router *1(2-25m)
 9. Bluetooth Audio module *1 (5V)
 10. LED lighting system *1(12V/10W light sense/time control)
- Size: 1800*650*735mm Color: customized

Optional features:

1. Intelligent dialog voice module
2. 5G router
3. Remote control system module (mobile phone real-time view status)
4. Power display module
5. One-click alarm system
6. Mains function

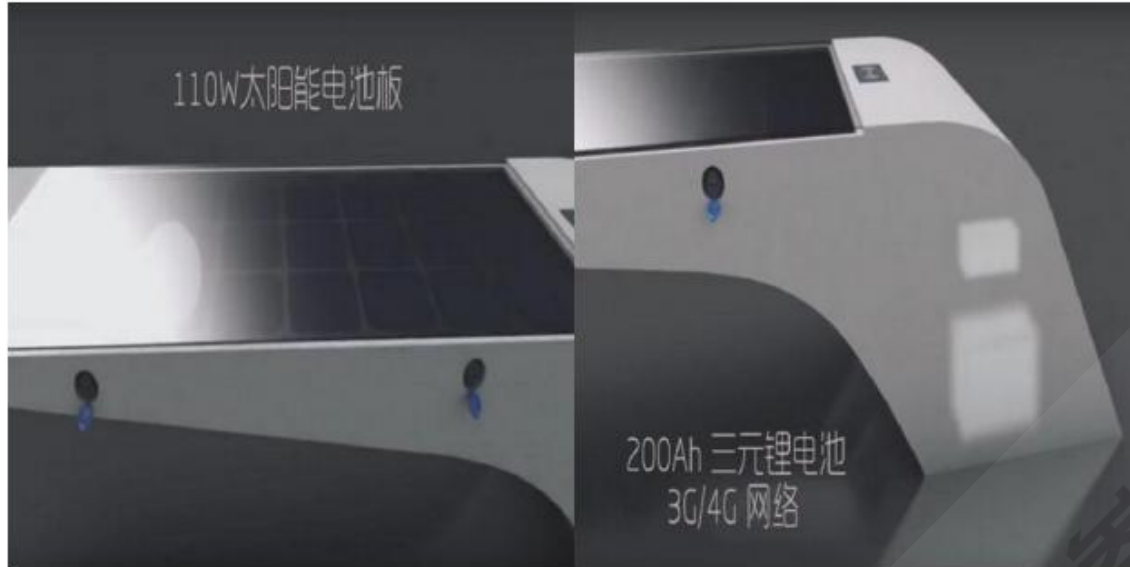

Product model: SVIP-3A21-23

1. Smart chair main structure: 1.5mm galvanized steel plate
2. Monocrystalline silicon solar panel power generation system: 80W
3. Photovoltaic intelligent control system (MPPT export level)
4. Lithium iron phosphate battery * 1:48AH
5. USB3.0 Fast Charging *2 (5V/2.1A)
6. Wireless charging module *2(5V-2A,10W)
7. Voltage conversion module *1(12V-5V/20A/22W)
8. WiFi*1 4G router *1(2-25m)
9. Bluetooth Audio module *1 (5V)
10. LED lighting system *1(12V/10W light sense/time control)

Size: 1700*450*450mm Color: white

Optional features:

1. Intelligent dialog voice module
2. 5G router
3. Remote control system module (mobile phone real-time view status)
4. Power display module
5. One-click alarm system
6. Mains function



Product model: SVIP-3A21-2A

1. Smart chair main structure: 1.5mm galvanized steel plate
2. Monocrystalline silicon solar panel power generation system: 80W
3. Photovoltaic intelligent control system (MPPT export level)
4. Lithium iron phosphate battery * 1:48AH
5. USB3.0 Fast Charging *2 (5V/2.1A)
6. Wireless charging module *2(5V-2A,10W)
7. Voltage conversion module *1(12V-5V/20A/22W)
8. WiFi*1 4G router *1(2-25m)
9. Bluetooth Audio module *1 (5V)
10. LED lighting system *1(12V/10W light sense/time control)

Size: 1700*550*450mm/1700*1100*735mm Color: customized

Optional features:

1. Intelligent dialog voice module
2. 5G router
3. Remote control system module (mobile phone real-time view status)
4. Power display module
5. One-click alarm system
6. Mains function

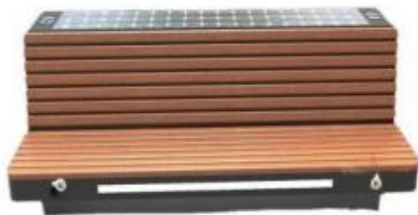

Product model: SVIP-3A21-25

1. The main structure of the smart chair: 1.5mm galvanized steel plate, anti-corrosion wood/plastic wood
2. Monocrystalline silicon solar panel power generation system power: 100W
3. Photovoltaic intelligent control system (MPPT export level)
4. Lithium iron phosphate battery * 1:48AH
5. USB3.0 Fast charging *4 (5V/2.1A)
6. Wireless charging module *2(5V-2A,10W)
7. Voltage conversion module *1(12V-5V/20A/22W)
8. WiFi*1 4G router *1(2-25m)
9. Bluetooth Audio module *1 (5V)
10. LED lighting system *1(12V/10W light sense/time control)

Size: 2000*1500*800mm Color: customized

Optional features:

1. Intelligent dialog voice module
2. 5G router
3. Remote control system module (mobile phone real-time view status)
4. Power display module
5. One-click alarm system
6. Mains function



Product model: SVIP-3A21-26

1. Main structure of charging pile: 1.5mm galvanized steel plate
2. Monocrystalline silicon solar panel power generation system: 45W
3. Photovoltaic intelligent control system (MPPT export level)
4. Lithium iron phosphate battery * 1:30 AH
5. USB3.0 Fast Charging *2 (5V/2.1A)
6. Wireless charging module *3(5V-2A,10W)
7. Voltage conversion module *1(12V-5V/20A/22W)
8. WiFi*1 4G router *1(2-25m)
9. Bluetooth Audio module *1 (5V)

Size: 350*350*2360mm Color: customized

Optional features:

1. 5G router
2. Remote control system module (mobile phone real-time view status)
3. One-click alarm system
4. Mains function





Product model: SVIP-3A21-27

1. Main structure of charging pile: 1.5mm galvanized steel plate
2. Monocrystalline silicon solar panel power generation system: 80W
3. Photovoltaic intelligent control system (MPPT export level)
4. Lithium iron phosphate battery * 1:48AH
5. USB3.0 Fast Charging *2 (5V/2.1A)
6. Wireless charging module *3(5V-2A,10W)
7. Voltage conversion module *1(12V-5V/20A/22W)
8. WiFi*1 4G router *1(2-25m)
9. Bluetooth Audio module *1 (5V)

Size: 550*550*2360mm Color: customized

Optional features:

1. 5G router
2. Remote control system module (mobile phone real-time view status)
3. One-click alarm system
4. Mains function

Thank You

Hangzhou Sanqian Smart City Technology Co., Ltd. solar smart seat products production process: laser cutting, laser cutting, welding, grinding, scraping, epoxy fluorocarbon primer, outdoor metal paint, assembly, commissioning, packaging, wood frame, transportation. China's SVIP-3A21 series solar seat supplier, manufacturer and factory - Hangzhou Sanqian Smart City Technology Co., LTD. We are high quality SVIP-3A21 series solar seats made in China, with advanced technology. You can rest assured to buy our SVIP-3A21 series solar seats, if you need our quotation, we can provide the price list.